

**7 Farriers Croft, Bussage, Stroud,  
Gloucestershire, GL6 8JW**

**Guide Price £290,000**

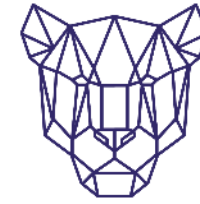

**PANTERA  
PROPERTY**



7 Farriers Croft, Bussage, Stroud,  
Gloucestershire, GL6 8JW

Guide Price £290,000

- Mid terraced house
- Allocated parking
- Freehold
- No Onward Chain
- Cul-de-sac location
- Private rear garden

Contacts:

To enquire about this property or for further  
information, please get in touch with:

Amy White

0330 118 6610

[amy@panteraproperty.com](mailto:amy@panteraproperty.com)

Misrepresentation Act; 1. Pantera Property Limited on its own behalf of the vendor/lessor of this property whose agent Pantera Property Limited is, gives notice that: (a) these particulars do not constitute in whole or in part an offer or contract for sale or lease; (b) none of statements contained in these particulars as to the property are to be relied on as statements or representations of fact; and (c) the vendor/lessor does not make or give I, and neither Pantera Property Limited nor any of its members or any person in its employment has any authority to make or give, any representation or warranty whatsoever in relation to the property. The only representations, warranties, undertakings and contractual obligations to be given or undertaken by the vendor/lessor are those contained and expressly referred to in the written contract for sale or agreement for lease between the vendor/lessor and a purchase or tenant. 2. Prospective purchasers or tenants are strongly advised to: (a) satisfy themselves as to the correctness of each statement contained in these particulars; (b) inspect the property and the neighbouring area; (c) ensure that any items expressed to be included are available and in working order; (d) arrange a full structural (and where appropriate environmental) survey of the property; and (e) carry out all necessary searches and enquiries. Pantera Property is the trading name of Pantera Property Limited, October 2022.



PANTERA  
PROPERTY

## DESCRIPTION

Pantera Property offer to the market a three-bedroom mid terraced house, providing generous gardens to the front and rear. The property also boasts two car parking spaces, parking is accessed to the rear of the property.

The property is well presented and benefits from gas central heating. Viewing is highly recommended.



## LOCATION

The property is located in Bussage, a village in Gloucestershire within the district of Stroud. Bussage lies approximately four miles south east of the centre of Stroud. The property itself lies within the centre of Bussage and is surrounded by predominantly residential dwellings. The amenities in the immediate area are minimal other than a Tesco Express. There is no train station within close proximity to the subject property. However, there is a bus stop within ten minutes walk which provides services to Stroud. From Stroud, train services are provided to Gloucester within approximately 15 minutes and other local services.

## VIEWINGS

Please call Amy at Pantera Property for viewing arrangements.

Score	Energy rating	Current	Potential
92+	A		
81-91	B		86 B
69-80	C		
55-68	D	60 D	
39-54	E		
21-38	F		
1-20	G		

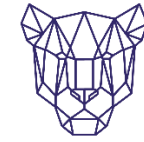

PANTERA  
PROPERTY



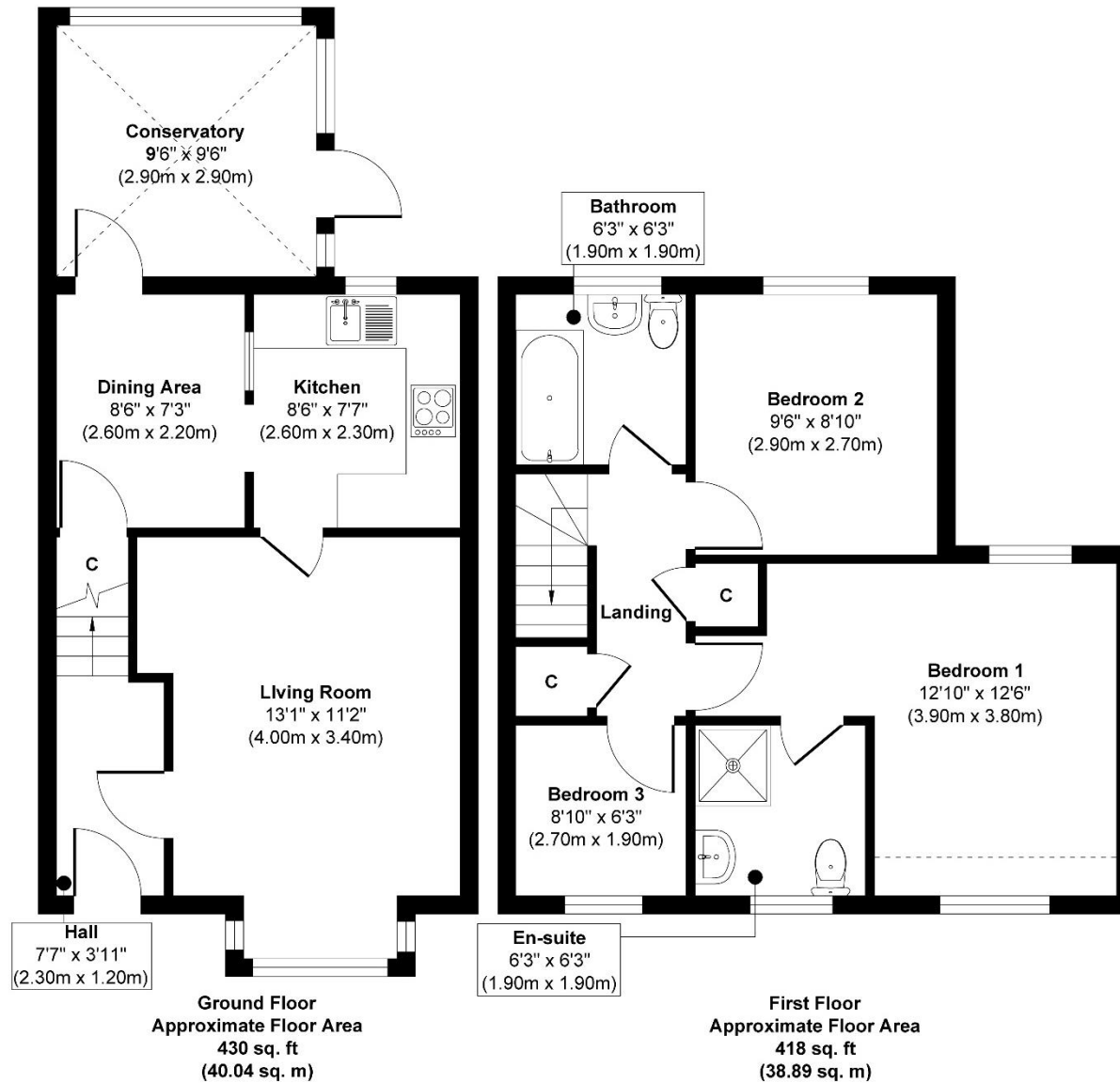
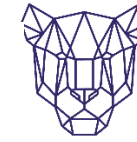

**Approx. Gross Internal Floor Area 848 sq. ft / 78.93 sq. m**

Whilst every attempt has been made to ensure the accuracy of the floor plan contained here, measurements of doors, windows, rooms and any other items are approximate and no responsibility is taken for any error, omission, or mis-statement. The measurements should not be relied upon for valuation, transaction and/or funding purposes. This plan is for illustrative purposes only and should be used as such by any prospective purchaser or tenant.